

JETAX Circular Smoke Jet

JETAX - C



- Units available in single or dual airflow direction
- Assembly consists of fan, silencers, deflectors and brackets
- Safety screens in accordance with UNE 100250 on single direction models
- Units are suitable for 300°C / 120min operation except where indicated in table below
- Sheet metal casing and motor pedestal
- Cast aluminium, variable pitch
- Highly effective silencers with thermal and acoustic insulation
- Motors Class H, S1 and S2 cycle, IP55 protection, 2 speed

On special request;

- Special windings for different voltages
- Fans designed for max operating 400°C

JETAX-C – Circular Smoke Fans

Technical Characteristics

Model	Speed	Full Load Amps @ 400V	Max Flow (m ³ /h)	Thrust (N)	Discharge Velocity (m/sec)	Installed Power (kW)	Sound Pressure at 10m (dBa)	Mass (kg)
Jetax-31-C *	2880 / 1420	1.25 / 0.45	4260 / 2130	21 / 5	15.6 / 7.8	0.55 / 0.11	51/36	57
Jetax-35-C *	2890 / 1415	1.90 / 0.70	6360 / 3180	36 / 9	17.8 / 8.9	0.85 / 0.20	52/37	61
Jetax-38-C *	2905 / 1440	2.50 / 0.90	8450 / 4225	57 / 15	20.7 / 10.3	1.10 / 0.25	47/32	85
Jetax-40-C	2905 / 1440	2.50 / 0.90	9250 / 4625	60 / 15	20.4 / 10.2	1.10 / 0.25	53/38	94
Jetax-45-C-2	2935 / 1450	3.80 / 1.20	10800 / 5400	62 / 15	18.1 / 9.0	1.5 / 0.37	57/42	125
Jetax-45-C-3	2910 / 1420	5.00 / 1.60	13200 / 6600	92 / 23	22.1 / 11.0	2.20 / 0.60	58/44	127
Jetax-50-C	2910 / 1440	8.50 / 3.00	19700 / 9850	165 / 41	26.4 / 13.2	4.50 / 1.30	60/46	210
Jetax-56-C	2920 / 1450	20.7 / 5.50	27900 / 13950	278 / 69	31.5 / 15.7	9.0 / 2.50	64/50	273
Jetax-63C	2965 / 1480	27.2 / 7.50	38800 / 19400	411 / 103	33.5 / 16.8	13.5 / 3.30	68/53	323
Jetax-71-C	1430 / 710	6.50 / 2.30	26600 / 13300	157 / 39	18.7 / 9.3	3.0 / 0.60	65/50	279
Jetax-31-C-R *	2880 / 1420	1.25 / 0.45	3840 / 1920	17 / 4	14.1 / 7.0	0.55 / 0.11	50/35	57
Jetax-35-C-R *	2890 / 1415	1.90 / 0.70	5940 / 2970	31 / 8	16.7 / 8.3	0.85 / 0.20	51/36	61
Jetax-38-C-R *	2935 / 1450	3.80 / 1.20	8200 / 4100	54 / 14	20.1 / 10.0	1.50 / 0.37	49/34	85
Jetax-40-C-R	2935 / 1450	3.80 / 1.20	9250 / 4625	60 / 15	20.4 / 10.2	1.50 / 0.37	52/37	94
Jetax-45-C-2-R	2935 / 1450	3.80 / 1.20	10300 / 5150	56 / 14	17.2 / 8.6	1.50 / 0.37	56/41	125
Jetax-45-C-3-R	2910 / 1420	5.00 / 1.60	12800 / 6400	87 / 22	21.4 / 10.7	2.20 / 0.60	57/43	127
Jetax-50-C-R	2910 / 1440	8.50 / 3.00	19000 / 9500	153 / 38	25.4 / 12.7	4.50 / 1.30	60/46	210
Jetax-56-C-R	2920 / 1450	20.7 / 5.50	27000 / 13500	261 / 65	30.5 / 15.2	9.00 / 2.50	63/49	273
Jetax-63C-R	2965 / 1480	27.2 / 7.50	37800 / 18900	390 / 98	32.6 / 16.3	13.5 / 3.30	67/52	323
Jetax-71-C-R	1430 / 710	6.50 / 2.30	26000 / 13000	150 / 37	18.2 / 9.1	3.0 / 0.60	64/49	279

* Models are suitable for 200°C / 2 hours R – Reversible Units

Any information published in this pamphlet is subject to change without prior notice.

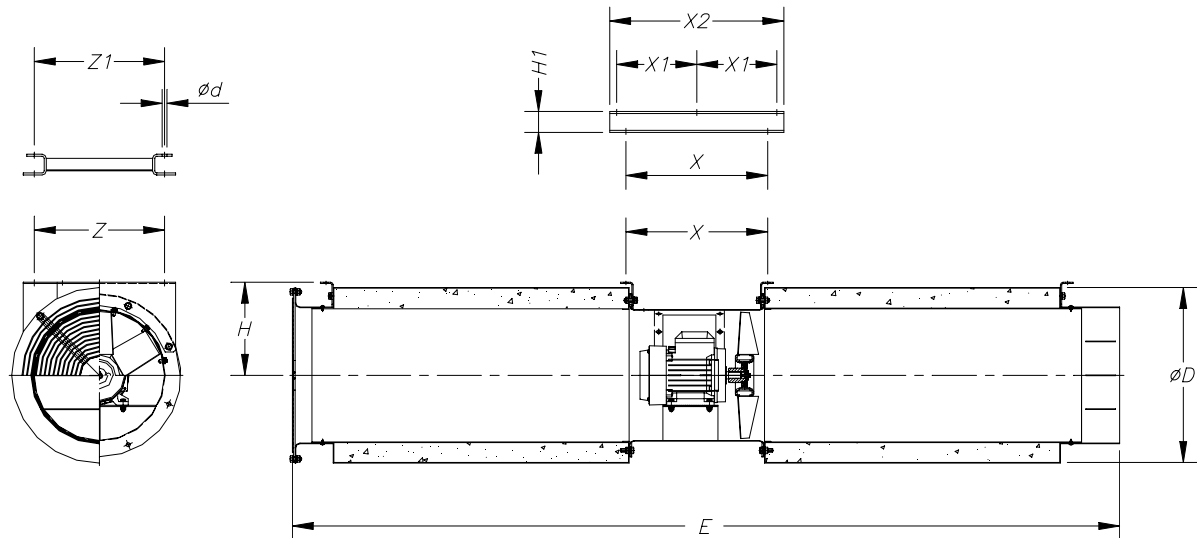

	ØD	Ød	E (Uni)	E (Rev)	H	H1	X	X1	X2	X3	Z	Z1
Jetax-31-C	415	10	1956	2000	220	-	335	-	-	-	275	-
Jetax-35-C	460	12	1960	2005	250	-	336	-	-	-	300	-
Jetax-38-C	415	11	2570	2620	225	-	-	-	600	530	-	517
Jetax-40-C	510	12	2485	2540	280	-	368	-	-	-	400	-
Jetax-45-C	630	12	2500	2554	355	-	385	-	-	-	440	-
Jetax-50-C	710	12	2895	2950	410	80	508	320	700	-	380	370
Jetax-56-C	750	12	3145	3200	503	80	558	345	750	-	475	465
Jetax-63-C	800	14	3295	3350	435	80	706	418	900	-	550	540
Jetax-71-C	900	12	3145	3200	510	80	558	345	750	-	475	465

	D(m)	L(m)
Jetax-31-C	10	20
Jetax-35-C	12	24
Jetax-38-C	14	28
Jetax-38-R	14	28
Jetax-40-C	15	28
Jetax-40-R	15	28
Jetax-45-C	17	34
Jetax-50-C	21	42
Jetax-56-C	25	50
Jetax-63-C	30	60
Jetax-71-C	25	50

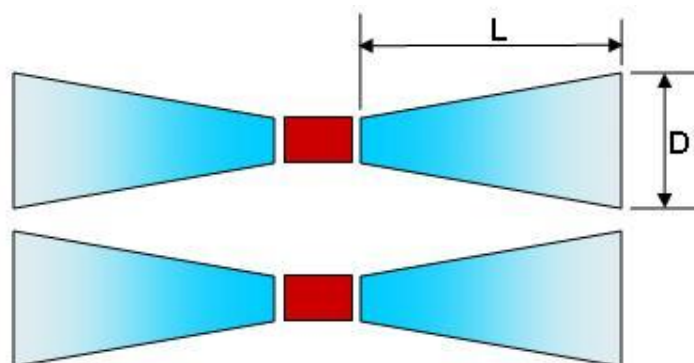

Any information published in this pamphlet is subject to change without prior notice.