



## JETAX Oval Smoke Jet

JETAX - O



- Units available in single or dual airflow direction
  - Assembly consists of fan, silencers, deflectors and brackets
  - Safety screens in accordance with UNE 100250 on single direction models
  - Sheet metal casing and motor pedestal
  - Cast aluminium, variable pitch
  - Models are suitable for 200°C / 120minutes operation
  - Highly effective silencers with thermal and acoustic insulation
  - Motors Class H, S1 and S2 cycle, IP55 protection, 2 speed
- On special request;*
- Special windings for different voltages
  - Fans designed for max operating 400°C

JETAX-O – Oval Smoke Fans

### Technical Characteristics

Model	Speed	Full Load Amps @ 400V	Max Flow (m <sup>3</sup> /h)	Thrust (N)	Discharge Velocity (m/sec)	Installed Power (kW)	Sound Pressure at 10m (dBa)	Mass (kg)
Jetax-29-O	2880 / 1420	1.25 / 0.45	4000 / 2000	21 / 5	16.8 / 8.4	0.55 / 0.11	37 / 22	65
Jetax-35-O	2890 / 1415	1.90 / 0.70	6360 / 3180	36 / 9	17.8 / 8.9	0.85 / 0.20	52 / 37	61
Jetax-29-O-R	2880 / 1420	1.25 / 0.45	3400 / 1700	15 / 4	14.3 / 7.1	0.55 / 0.11	38 / 23	65
Jetax-35-O-R	2890 / 1415	1.90 / 0.70	5940 / 2970	31 / 8	16.7 / 8.3	0.85 / 0.20	51 / 36	61

R – Reversible Units

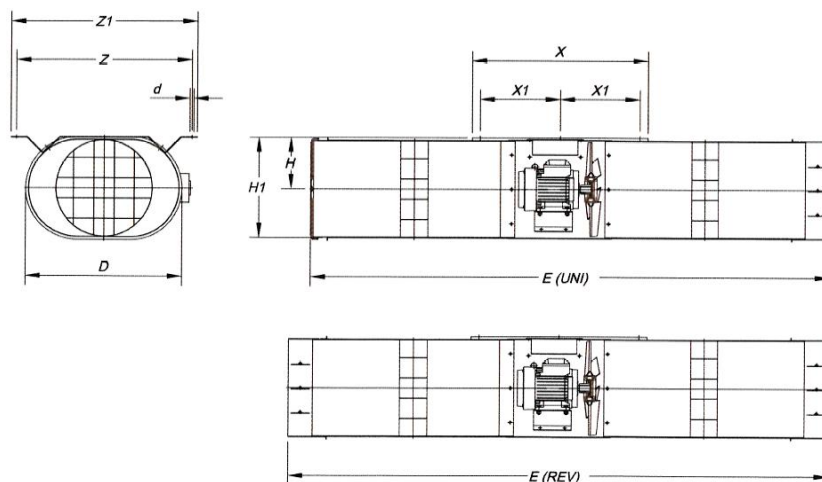

	ØD	Ød	E (Uni)	E (Rev)	H	H1	X	X1	Z	Z1
Jetax-29-O	460	12	2506	2600	160	310	700	330	550	590
Jetax-35-O	560	12	2005	2005	190	370	654	297	650	690

Any information published in this pamphlet is subject to change without prior notice.