

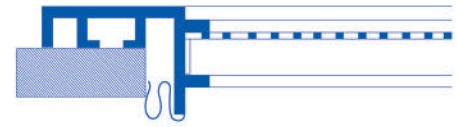

FIXING

1) CONCEALED TYPE FIXING
(WALL ONLY)



2) VISIBLE SCREW FIXING

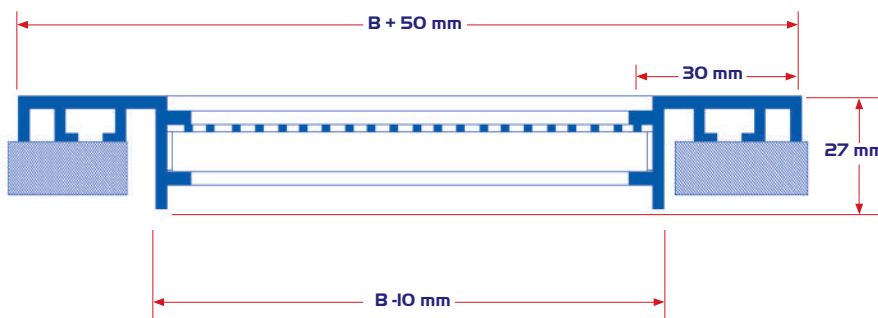
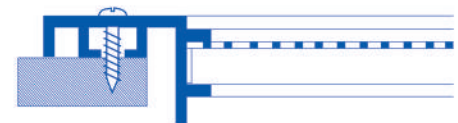

TYPE: PAG

- >> The perforated air grille is a wall/ceiling mounted air terminal device that is composed of perforated sheet fixed of a frame.
- >> The perforated sheet is made of galvanized steel 0.7 mm thickness.
- >> The frame is made of extruded aluminium bars.
- >> Perforated face has 3mm diameter holes in a staggered pattern as per shown drawing >>>
- >> The perforated air grilles are used in cooling, heating and air ventilation. They are usually used as return grilles.
- >> Insulating gasket is fixed on request around the back of the frame to prevent infiltration between the frame and the wall.

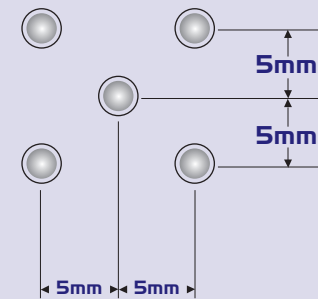

3mm diameter holes in a staggered pattern

FINISH

>> POWDER COATED TO RAL CODES

Ordering Key:

P	A	R	B	SIZE
PAR: PERFORATED AIR REGISTER (WITH OBD)				
PAG: PERFORATED AIR GRILLE (WITHOUT OBD)				
PAR/PAG: COMBINED				
-: WITHOUT OBD				
B: WITH BLACK OBD				
M: WITH MILL FINISH OBD				
SIZE: WIDTH X HEIGHT				

